

FAMILY

OKLAHOMA

EL RENO

SOUTHWEST

Elizabeth Place

1955 South Shepard Ave., El Reno, OK 73036

Office: 405.262.3621 | Fax: 405.262.0072

Email: elizabethplace@wilhoitproperties.com



OVERVIEW

Home Type: Apartment

Bedrooms: 1–3

Bathrooms: 1–2

Other: 0 Garage

Size: 722–1147 ft²

Built In: 2006

Property Description

Welcome to Elizabeth Place Apartments in beautiful El Reno, Oklahoma. Elizabeth Place is a family-friendly community with unique floor plans designs, fully equipped kitchens and private patio or balcony. Residents enjoy children's playgrounds, swimming pool, fitness center and picnic area with bbq grills. The apartments in this community participate in The Housing Choice Voucher Program designed to maintain affordable housing for residents. Please call to see your new home with Elizabeth Place today.

Schools

District: El Reno Public Schools

Rose Whitcher Elementary School

Leslie F. Roblyer Middle School

Etta Dale Junior High School

El Reno High School

AMENITIES

Units:

Unique Floor Plan Designs

Built-In Microwave & Self-Cleaning Oven

Refrigerator with Ice Maker

Patios or Balcony with Storage (select floor plans)

Full-Size Washer & Dryer INCLUDED

Property:

24-Hour Emergency Maintenance

Sparkling Swimming Pool

Bike Racks & Fitness Center

Picnic Area with BBQ Grills & Tables

Two Children's Playgrounds

Laundry Facility

CONNECT WITH US



FLOOR PLANS

1 Bedroom: 722 ft²

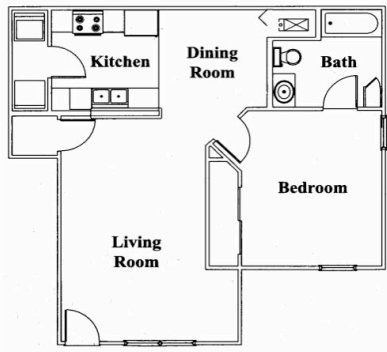

One Bedroom / One Bath 722 Square Feet

2 Bedroom: 973 ft²

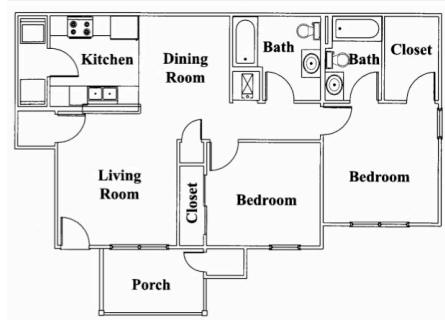

Two Bedroom / Two Bath 973 Square Feet

3 Bedroom: 1147 ft²

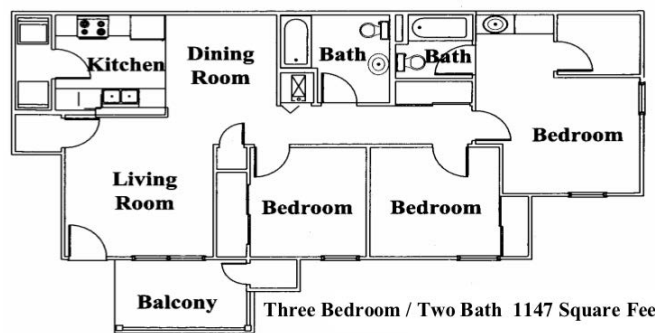

Three Bedroom / Two Bath 1147 Square Feet

OWNERSHIP & PARTNERS

Developer



Property Manager



Construction Management



Other Partners:

Oklahoma Housing Finance Agency, Centerline Capital,
Bancorp South, Native American Housing Services

CREDIT CARD PAYMENTS

The following credit cards are accepted forms of rent payment in the Residential Portal.

